

Dated: 15 SEPTEMBER 2021

FOREST OF DEAN DISTRICT COUNCIL

LYDNEY Footpath No FLY87

PUBLIC PATH DIVERSION ORDER 2021

TOWN & COUNTRY PLANNING ACT 1990 SECTION 257

FOREST OF DEAN DISTRICT COUNCIL

LYDNEY Footpath No FLY87 (Part)
PUBLIC PATH DIVERSION ORDER 2021

THIS ORDER is made by FOREST OF DEAN District Council under section 257 of the Town and Country Planning Act 1990 because it is satisfied that it is necessary to divert the Footpath to which this Order relates to enable development to be carried out in accordance with planning permission granted under Part III of the Town and Country Planning Act 1990 namely the reserved matters (Access, Appearance, Landscaping, Layout and scale) for outline planning permission P0361/15/OUT for the erection of 148 dwellings, open space, infrastructure and ancillary works at land between Lydney bypass and Highfield Road Highfield Road Lydney Gloucestershire.

BY THIS ORDER:

- 1 The footpath over the land shown by a bold black line on the attached map and described in Part 1 of the Schedule to this Order ("the Schedule") shall be diverted as provided below.
- 2 There shall be created to the reasonable satisfaction of Gloucestershire County Council an alternative highway for use as a replacement for the said footpath as provided in Part 2 of the Schedule and shown by bold black dashes on the attached map.
- 3 The diversion of the footpath shall have effect on the date on which Gloucestershire County Council certify that the terms of Article 2 have been complied with.
- 4 Where immediately before the date on which the footpath is diverted there is apparatus under, in, on, over, along or across it belonging to statutory undertakers for the purpose of carrying on their undertaking, the undertakers shall continue to have the same rights in respect of the apparatus as they then had.

SCHEDULE

PART 1

The entire width of that length of LYDNEY Footpath FLY87 running from OSGR SO 6449/0363 (Point A) in an east north-east direction for approximately 189m to OSGR SO 6466/0369 (Point B) as shown between Points A – B on the plan attached to this Order.

PART 2

A new Footpath with a unenclosed width of 2m running from OSGR SO 6449/0363 (Point A) in a south easterly direction for approximately 17m to OSGR SO 6450/0362 (Point C) then in an east north-east direction for approximately 163m to OSGR SO 6465/0367 (Point D) and returning in a northerly direction for approximately 30m to meet the existing route at OSGR SO 6466/0369 (Point B) as shown between points A – C – D – B (total length approximately 210m).

The footpath is to be finished to Gloucestershire County Council shared surface carriageway and footway specifications.

DATED 15TH DAY OF SEPTEMBER 2021

THE SEAL OF FOREST OF DEAN)
DISTRICT COUNCIL WAS HEREUNTO)
AFFIXED IN THE PRESENCE OF)

Authorised Officer

P.M. Williams



THE ABOVE ORDER WAS CONFIRMED
AS AN UNOPPOSED ORDER BY
FOREST OF DEAN DISTRICT COUNCIL
3RD NOVEMBER 2021

P.M. Williams

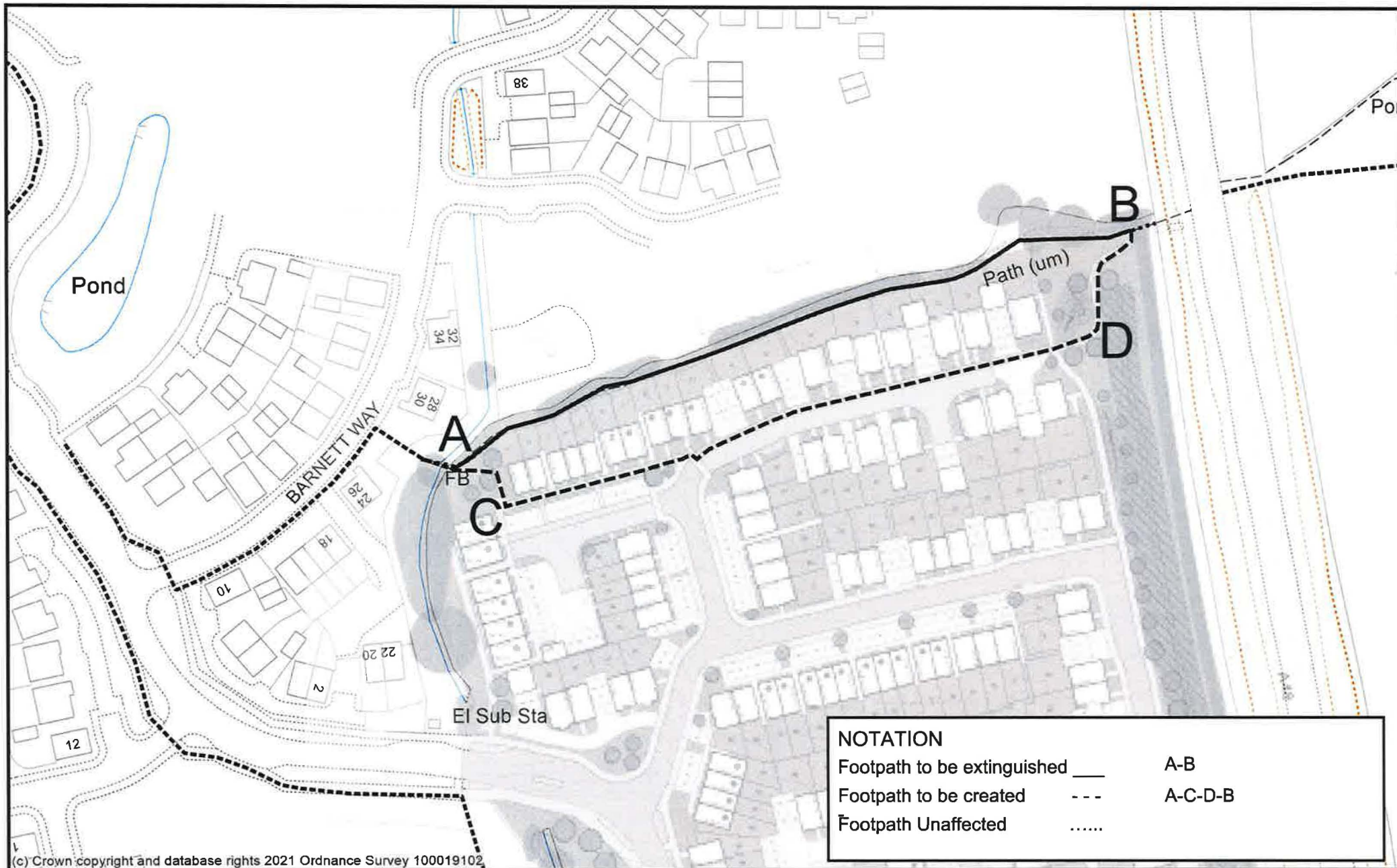

Public Footpath Diversion
Public Right of Way FLY87, Lydney

Scale: 1:1250

13 April 2021



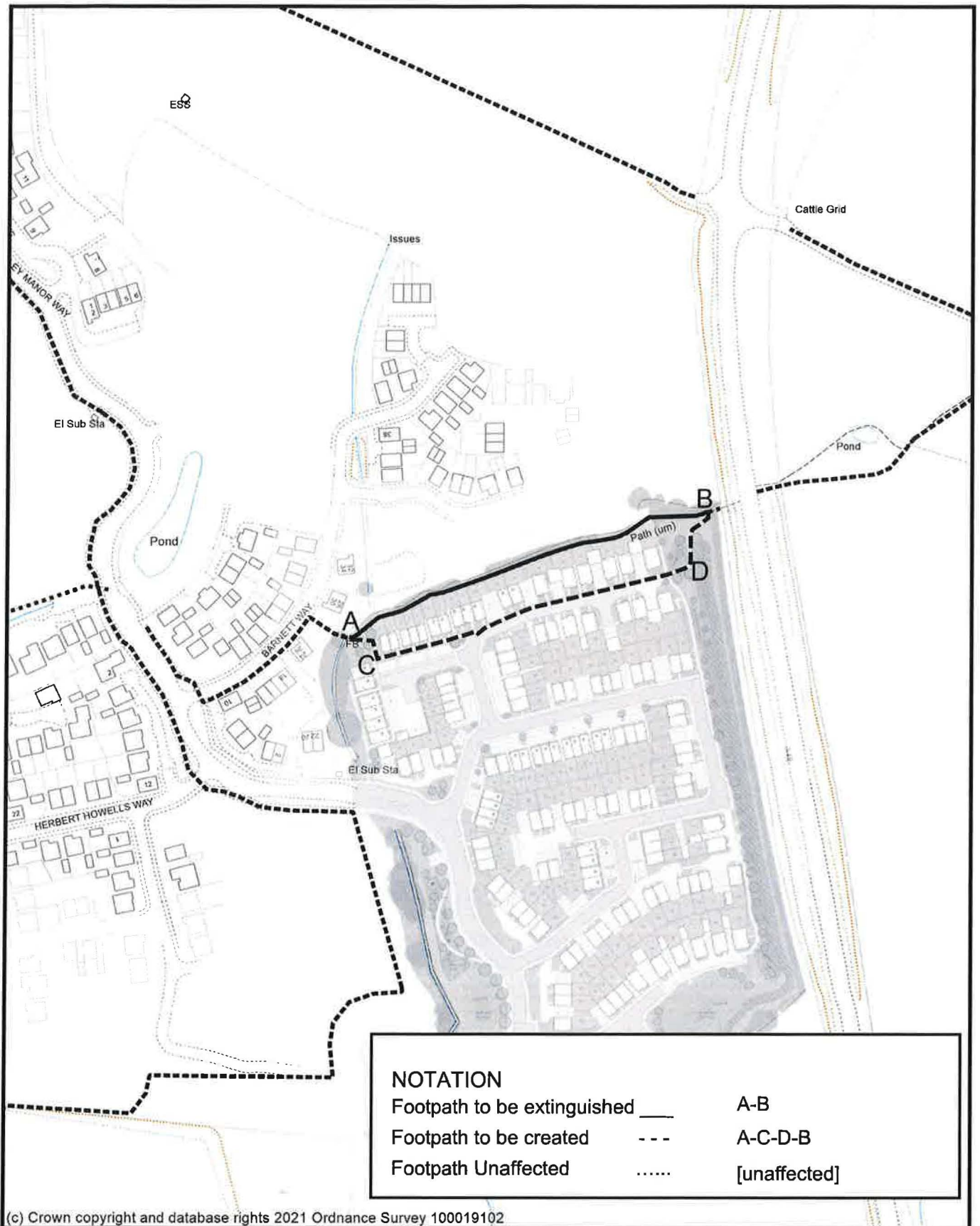

Public Footpath Diversion
Public Right of Way FLY87, Lydney

Scale: 1:2500
13 April 2021

